



LED ATTACHMENT //

User Manual

VERSION 1
SEPT 2023

TABLE OF CONTENTS

LED ATTACHMENT II INTRO.....	1
OVERVIEW	1
FEATURES.....	1
INCLUDED ITEMS	2
SAFETY GUIDE.....	3
SAFE MOUNTING	4
HARDWARE OVERVIEW.....	5
UNIT REAR.....	5
UNIT BOTTOM	5
HARDWARE SPECIFICATIONS.....	6
QUICK START DMX GUIDE.....	7
MENU SCREEN	8
DMX ADDRESSING	8
MENU SCREEN	9
DMX MODES	10
DMX PERSONALITIES	10
DMX MODES	12
COLOR MACROS	12
DEVICE TROUBLESHOOTING	13
INCLUDED WARRANTY.....	14
TERMS & CONDITIONS.....	15
CONTACT US	16

LED ATTACHMENT II INTRO

Congratulations on your purchase of the LED Attachment II This manual will provide an overview of the LED Attachment II's functions, capabilities, and instructions for proper operation. If you have questions outside the scope of this manual, feel free to contact us directly.

OVERVIEW

The Club Cannon LED Attachment II is a accessory designed for use with the Club Cannon DMX Jet MKII and the Club Cannon Pro Jet.

The LED Attachment II is a powerful and versatile lighting fixture designed for ease of use and dynamic performance. Its quick attachment design simplifies installation, saving time and effort. The fixture supports multi-zone control, allowing operators to create complex and layered lighting effects. With DMX control, it offers wide compatibility and can be easily integrated into existing DMX systems. The addition of Remote Device Management (RDM) functionality facilitates remote operation and maintenance of the device.

The LED Attachment II utilizes high-power 20W LEDs that support Red, Green, Blue, White, Amber, and UV color ranges. This wide color range, combined with the device's support for multiple operating modes from 2 to 14 DMX channels, offers an impressive level of control and flexibility. The 10-degree beam angle is perfect for delivering focused and intense lighting on the CO2 plume.

Secure and reliable power connections are ensured through the use of Neutrik True1 connectors for power input and output. For improved setup cleanliness and easier cable management, the power and DMX ports are conveniently located on the bottom of the device.

FEATURES

- Quick Attachment
- Multi-Zone Control
- DMX Controlled
- 6 x 20W LEDs
- RGBWA+UV LEDs
- 2CH - 14CH Modes
- 10DEG Beam Angle
- Magnetic Mounting
- Neutrik True1 Input
- Neutrik True1 Output
- Bottom Located ports
- LED Display



Necessary precautions should be taken when using FX products to ensure the safety of the operator, crew, and audience.

Do not operate this product, or any special effects product without proper knowledge and training. Never operate Special Effects Equipment under the influence of drugs or alcohol.

INCLUDED ITEMS

The following items are included with the purchase of each LED Attachment II. If you need replacement items, contact Club Cannon, 888-804-8175 / info@clubcannon.com.



LED ATTACHMENT II

DMX controlled LED accessory



TRUE1 JUMP CABLE

15" PowerCon True1 jumper cable for connecting to jet.



SAFETY RING

Can be mounted to fixture when unit is mounted above people.



DMX JUMP CABLE

13" 5-pin DMX jumper cable for connecting to jet

SAFETY GUIDE



DANGER

This icon signifies that severe bodily harm or death *will* occur if instructions are not followed.



WARNING

This icon signifies that severe bodily harm or death *may* occur if instructions are not followed.



NOTICE

This icon signifies that mild to moderate injury may occur if instructions are not followed.



CAUTION

This icon signifies product malfunction or damage may occur if instructions are not followed.

To ensure safe operation, user must follow instructions closely. Necessary protocols should be followed when handling and operating Special Effects Equipment and their respective consumables.

- **Never place objects of any kind inside barrels.**
- **Never aim or fire the products at any person or living thing.**
- **This product is meant to be used only in well-ventilated areas.**

When using the products, always follow the safety radius displayed in this manual.

Once the product is attached to the CO₂ tanks and the tanks are turned on, the product, hoses and fittings will be under high pressure. Do not disconnect any fittings or hoses until the tank has been turned off, and the remaining gas has been cleared through the product, depleting all pressure in the system. If a leak is detected, cease use of the product immediately. Never stand directly over unit while under pressure. Jets should be mounted or fixed in a safe place. When using Jets above ground, always use a safety cable in the event the Product's mount or fixture should fail. You must supply the safety cable(s) to use with this product. If you are under 18, you should not be using this product.

PREVENTING SERIOUS INJURY OR DEATH

CO₂ Special Effects are to only to be used in well ventilated areas. Failure to do so may result in oxygen displacement.

Maintain a safe distance between Special Effects Products and audience, crew & event staff. Refer to the safety radius outlined in this manual.

Never aim Special Effects Products directly at any person or living thing.

Always fasten tanks to avoid tipping, rocking, or being tampered with. When feasible, keep tanks out of direct sunlight.

Check with officials in local jurisdiction for any permit requirements before operating Special Effects.



WARNING

Carbon dioxide is known as an asphyxiant gas. Carbon dioxide poisoning has been linked to various health issues, including central nervous system damage, permanent deterioration of respiratory functions, suffocation or even death. If you have any health concerns that may be related to the Product's use of carbon dioxide, consult your doctor before using any of the Products.

- CO₂ Levels can be measured using a CO₂ Monitor.
- 5,000 PPM is the workplace exposure limit in most jurisdictions.
- Check with your local agency to verify any need for permits in your area.

SAFETY GUIDE

SAFE MOUNTING

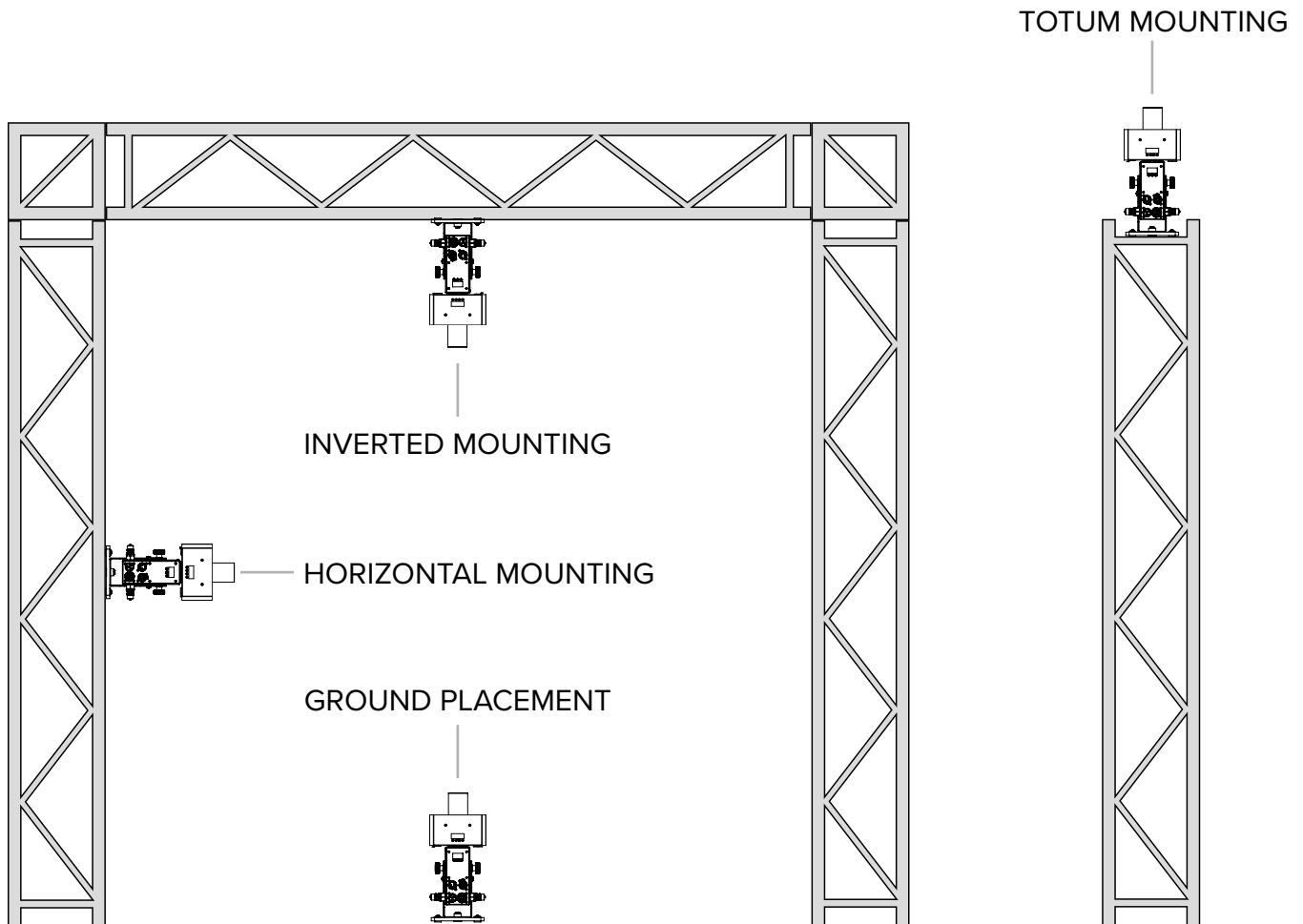

<p>GROUND PLACEMENT</p>	<ul style="list-style-type: none"> • Recommended use. LED Attachment can be mounted to unit easily by placing over barrel
<p>HORIZONTAL MOUNTING</p>	<ul style="list-style-type: none"> • Horizontal mounting requires a solid mounting surface. • If using truss, the structure MUST have adequate ballast to support the weight & recoil force of product. Safety cable and ring must be used with LED Attachment. • NEVER mount to flown/hung truss.
<p>INVERTED MOUNTING</p>	<ul style="list-style-type: none"> • Due to the output from this unit, the minimum safety radius must be followed. Unless this is possible to achieve, inverted mounting MUST be avoided. Safety cable and ring must be used with LED Attachment. • NEVER mount to flown/hung truss.
<p>TOTUM MOUNTING</p>	<ul style="list-style-type: none"> • Totum mounting can be utilized, provided the user has a secure fastening method of product to totum structure.

HARDWARE OVERVIEW

UNIT REAR

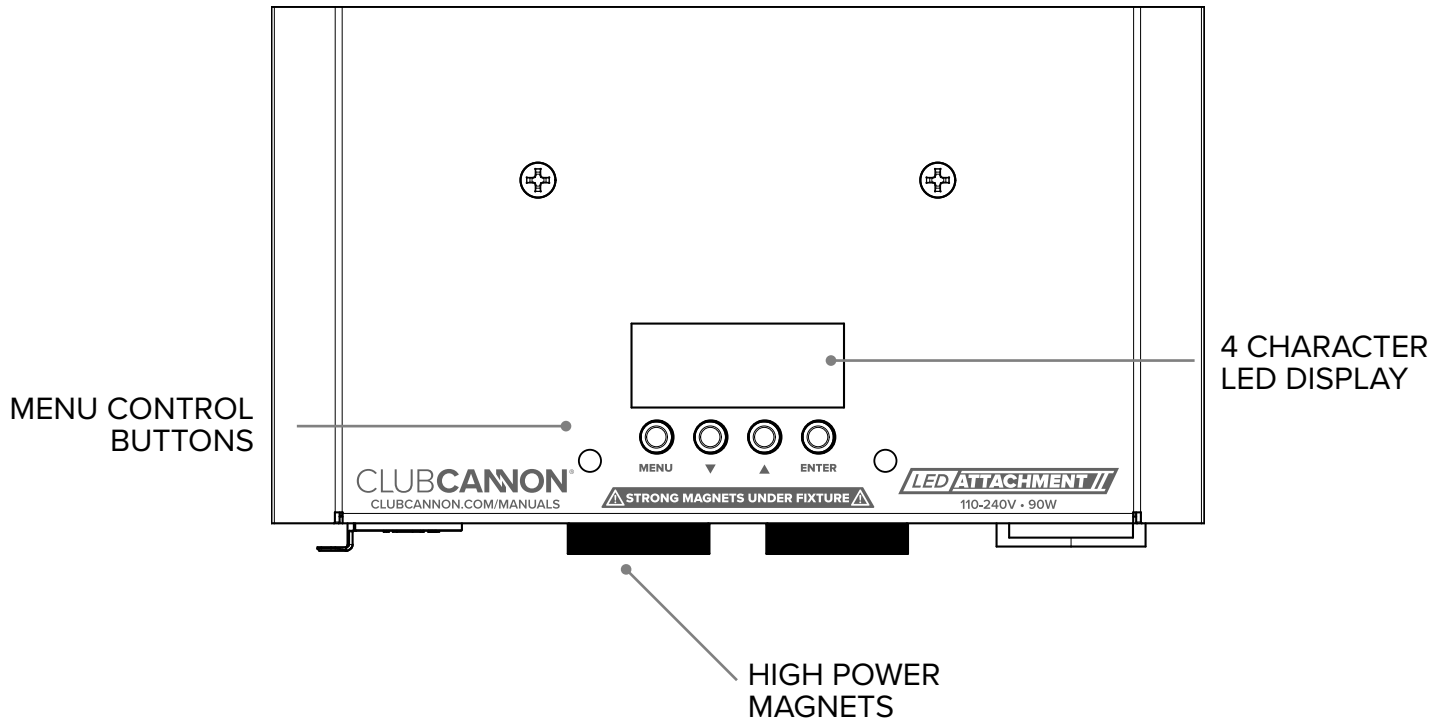

UNIT BOTTOM

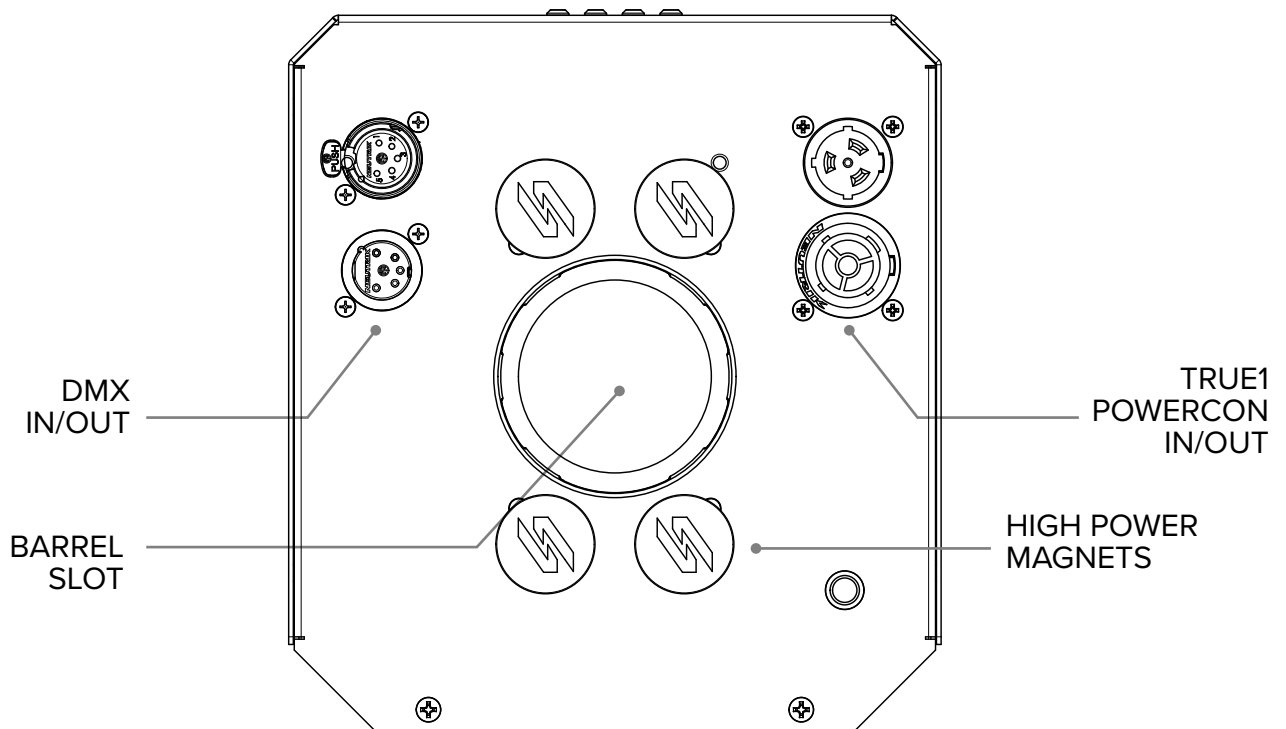

HARDWARE SPECIFICATIONS

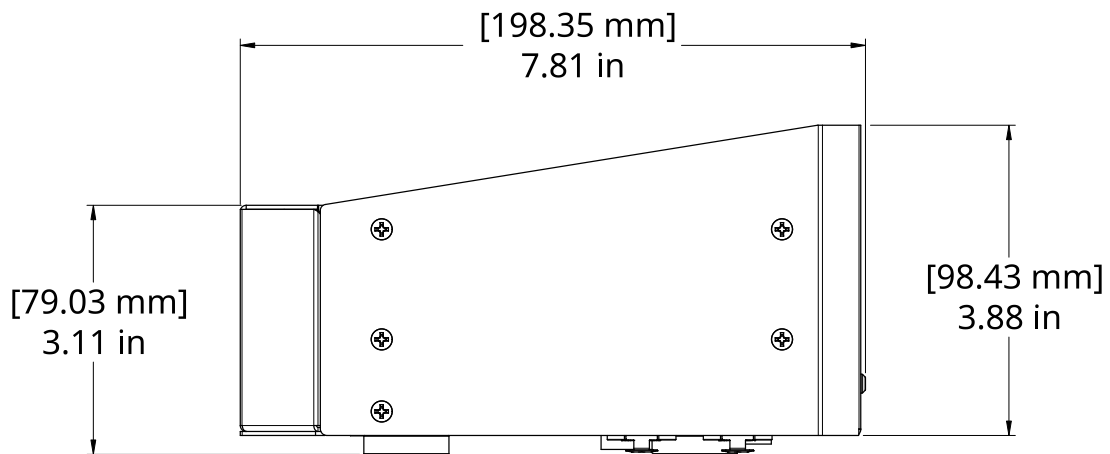
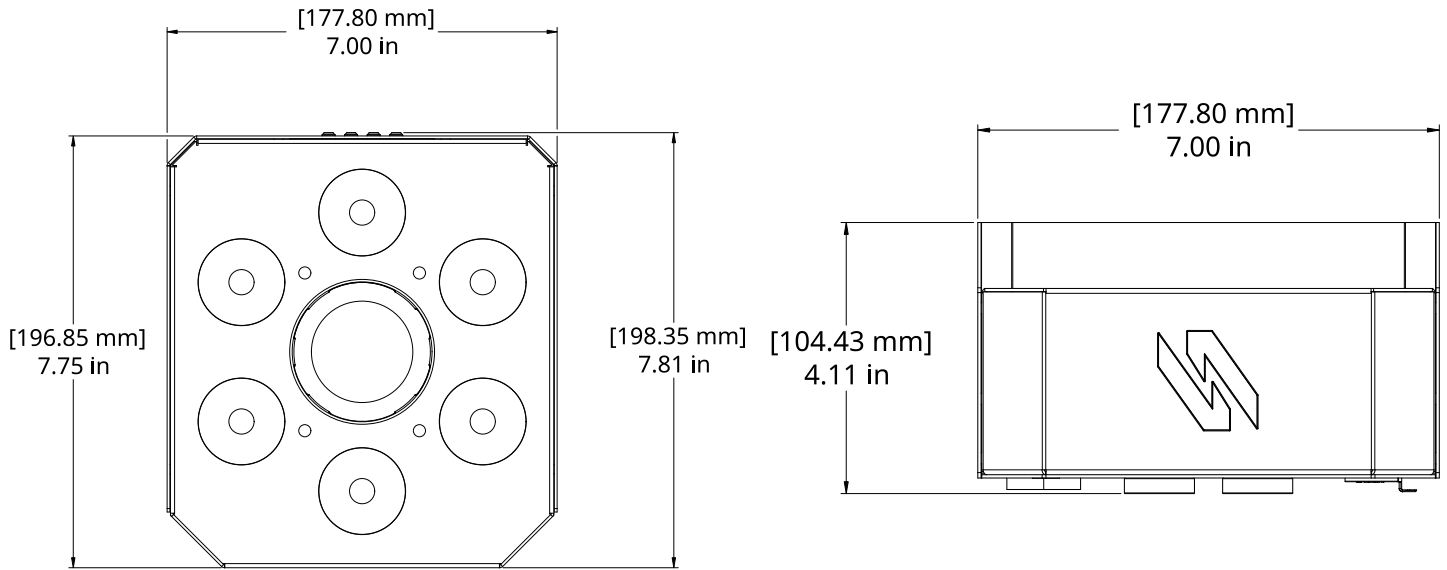

WEIGHT:	6 LBs 2.72 KGs	VOLTAGE:	110-240v AC 50-60hz
DIMENSIONS:	7.75" x 7.00" x 3.88" 196.85 mm x 177.80 mm x 98.43mm	CURRENT:	90W MAX
MOUNT:	4 x High power magnets 1 x Safety Ring	LIGHT:	6 x 20w RGBWA+UV LEDS 2 x Control Zones

QUICK START DMX GUIDE



1. Mount LED Attachment II

Slide the LED Attachment II over the barrel, making sure the sponge is sliding without catching. Be careful to not have fingers under magnets. True1 and DMX jumpers have been included for clean cabling to and from the fixture.



2. Boot LED Attachment II

The LED Attachment II AC power through the TRUE1 connector on the bottom of the product. The LED Attachment features an auto-switching power supply and accepts 110-240v AC.



3. Set DMX Addresses

The LED Attachment II is preaddressed to channel 2 in Extended Mode (9ch). This allow the fixture to work out of the box with Club Cannon DMX Controllers. Jet should be addressed to channel 1 for proper operation.



4. Connect DMX

The last step is to attach a DMX controller like “The Button”, “ShoStarter” or “ShoMaster” to control the Pro Jet and LED Attachment. The illuminated decimal point on the fixtures indicates that the unit(s) are receiving a DMX signal.

MENU SCREEN

This unit features quick access to setting the DMX address. This is the default screen that is shown when the LED Attachment II is first powered on.



DMX Status

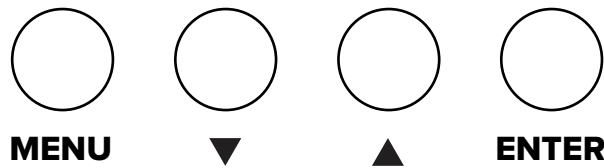

DMX ADDRESSING

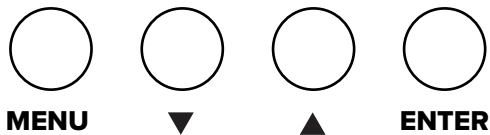

When the LED Attachment II is receiving DMX the unit will enter a lockout state. Fixture can be unlocked by removing DMX, or holding down any button for 5 seconds. This will unlock the system menu for reconfiguration.

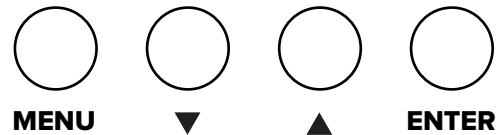

When addressing the LED Attachment, press “enter” to store address, or “menu” to cancel. If the unit is receiving DMX it will re-enter its lockout state after 30 seconds.

MENU SCREEN



ADDRESS

Depending on selected mode, DMX address can be set between 1-510.

MODES

- 2CH Mode (Simple)
- 5CH Mode (Basic)
- 8CH Mode (Raw)
- 9CH Mode (Extended)
- 14CH Mode (Tour)

FADE TIME

Fade out times can be set as follows:

- 0.5sec
- 1.0sec
- 1.5sec
- 2.0sec
- 2.5sec

INDICATOR LED

DMX indicator can be disabled to allow a fully blacked out display during operation.

DMX MODES

DMX PERSONALITIES

The LED Attachment II supports five modes of operation:

- 2-Channel Mode (Simple)
- 5-Channel Mode (Basic)
- 8-Channel Mode (Raw)
- 9-Channel Mode (Extended)
- 14-Channel Mode (Tour)

The mode can be selected by setting the personality from display or via RDM. Each mode interprets DMX input data in a different way, allowing for different levels of control over the LED's color and brightness.

The LED Attachment II supports various macro commands, such as setting a specific color or creating a color fade or jump see table of following page for more info.

The LED Attachment MKII supports strobe effects, which can be controlled using the strobe variable in the 5-channel, 8-channel, 9-channel, and 14-channel modes. The strobe frequency can be adjusted from 0.5hz Hz to 20 Hz.

Channel	Simple	Basic	Raw	Extended	Tour
1	Intensity	Intensity	Intensity	Intensity	Intensity
2	MACRO	RED	RED	RED	Red Zone 1
3		GREEN	GREEN	GREEN	Green Zone 1
4		BLUE	BLUE	BLUE	Blue Zone 1
5		STROBE	WHITE	WHITE	White Zone 1
6			AMBER	AMBER	Amber Zone 1
7			UV	UV	UV Zone 1
8			STROBE	MACRO	Red Zone 2
9				STROBE	Green Zone 2
10					Blue Zone 2
11					White Zone 2
12					Amber Zone 2
13					UV Zone 2
14					Strobe

DMX MODES

LED ZONES

The LED Attachment introduces a dual-zone control system in its 14-channel “TOUR” mode. This allows users to independently illuminate the front and back of the CO2 plume. Led zones are separated as seen below.

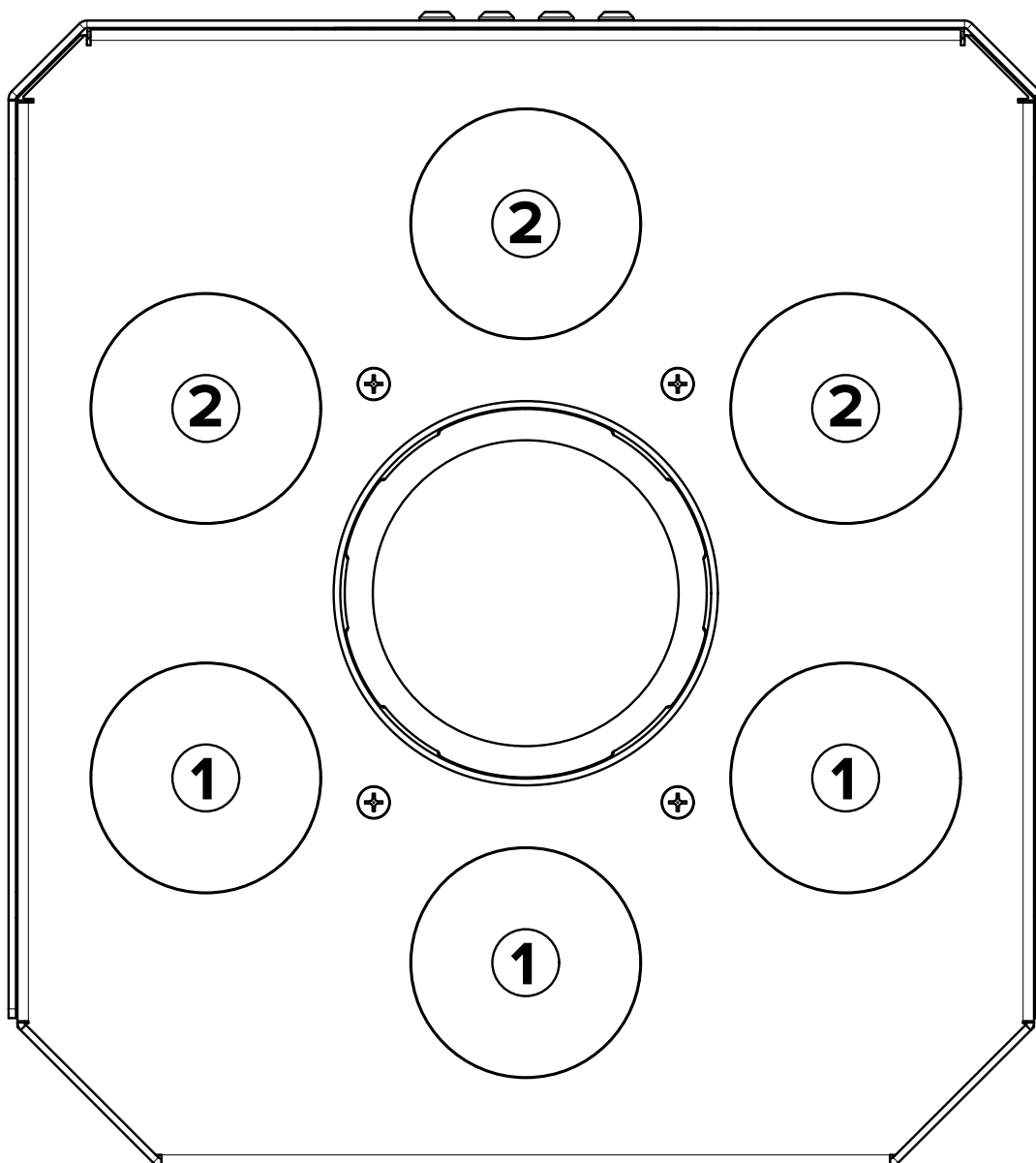

DMX MODES

COLOR MACROS

Along with direct individual color control, there are 10 color presets and 2 built in color effects.

See table below for more info:

MACRO	CHANNEL VALUE	RED	GREEN	BLUE	WHITE	AMBER	UV
COLOR MIX	0 - 12	Control Colors from individual color channels					
RED	13 - 25	255	0	0	0	0	0
GREEN	26 - 38	0	255	0	0	0	0
BLUE	39 - 51	0	0	255	0	0	0
CYAN	52 - 64	0	255	255	0	0	0
YELLOW	65 - 77	255	255	0	0	0	0
MAGENTA	78 - 90	255	0	255	0	0	0
AMBER	91 - 103	0	0	0	0	255	0
UV	104 - 116	0	0	0	0	0	255
CTO	117 - 129	255	255	0	255	140	0
UV+RED	130 - 150	255	0	0	0	0	255
COLOR FADE	151 - 200	RAINBOW FADE SLOW TO FAST					
COLOR JUMP	201 - 255	COLOR MACRO JUMP SLOW TO FAST					

DEVICE TROUBLESHOOTING

ISSUE	SOLUTION
Display Blank or Odd Characters	<ul style="list-style-type: none">• Reboot via power cycle.• If issue persists, contact Club Cannon directly.
Unit Resetting While Triggering	<ul style="list-style-type: none">• Make sure power supply is properly grounded.• If no earth ground is present, cease use immediately.
Unit Does Not Power On	<ul style="list-style-type: none">• Ensure correct voltage is being supplied to product.• Supplying incorrect voltage will cause permanent damage.• If issue persists, contact Club Cannon directly.
LEDs Appear Dim or Not Illuminating	<ul style="list-style-type: none">• This is a protective feature enabled when fixture detects abnormally high operating temperature.• Ensure you are operating fixture within specified temperature range, -20 - 120°F.• Ensure unit has sufficient cool down time between prolonged use.
Only Half of LEDs Illuminating	<ul style="list-style-type: none">• Ensure proper mode is selected. 14CH mode requires additional DMX channels to control 2nd zone of LEDs.• If issue persists, contact Club Cannon directly.
LED Colors Not Matching Command	<ul style="list-style-type: none">• Ensure unit is addressed properly.• Ensure unit is set to correct mode. (9CH mode required for proper operation with Club Cannon DMX controller pre-set modes).

No User Serviceable Parts Inside

If your issue is not listed, or the suggested solution did not solve the issue, contact Club Cannon.

888-804-8175 / info@clubcannon.com

INCLUDED WARRANTY

The LED Attachment II includes a 1 year parts & labor warranty against manufacturer defects. Warranty does not cover damage caused by accident, misuse, abuse, alteration, or unauthorized repair. To make a warranty claim, contact Club Cannon directly.



NOTICE

The LED Attachment II is an electronic device, sensitive to moisture. To avoid risk of electronic shock, malfunction, or voided warranty, only use in dry environments. Do not operate in harsh weather conditions. Do not block or insert anything into the jet's barrels.

This product should only be used by trained and qualified persons.

Club Cannon, LLC accepts no liability or responsibility for misuse or abuse of this product, nor any liability or responsibility of the products being used with the ShoMaster.

TERMS & CONDITIONS

Use of the Club Cannon® products is subject to the following Terms and Conditions:

Club Cannon® products (collectively, the “Product” or “Products”) are not toys. Any misuse of the Products could be extremely dangerous. Club Cannon® Products use carbon dioxide under high pressure to create special effects similar to a fog machine. They are not air cannons and should not be used to shoot projectiles in any fashion. Never place objects of any kind inside the barrel. Never aim or fire the Products at any person or living thing. Never hit any person or object with any of the Products. The Products are meant to be used only in well-ventilated areas. When using the Products, make sure you are in an open field or a well-ventilated area and are at least fifteen (15) feet away from people or other living things. Never hold a Club Cannon® Product by the barrel, especially after it has been used as it becomes extremely cold. Once the Product is attached to the CO₂ tank and the tank is turned on, the gas passing through the Product will be under pressure. Do not disconnect the fitting connecting the hose to the Product until the tank has been turned off and the remaining gas has been cleared through the product, depleting any pressure in the systems components. Stationary Club Cannon® units (collectively, the “Jets”) should be mounted or fixed in a safe place. When using the Jets above the ground, always use a safety cable in the event the Product’s mount or fixture should fail for any reason. You must supply the safety cable(s) to use with the Jets. If you are under 18, you should not be using the Products.

Carbon dioxide is known as an asphyxiant gas. Carbon dioxide poisoning has been linked to various health issues, including central nervous system damage, permanent deterioration of respiratory functions, suffocation or even death. If you have any health concerns that may be related to the Product’s use of carbon dioxide, consult your doctor before using any of the Products. To the extent you may have problems with your back, consult your doctor before using any of the Products in a portable fashion (such as, for illustration purposes only, using the Club Cannon® CO₂ Tank Backpack).

You must supply the carbon dioxide tank to use with the Products. Club Cannon, LLC, a California limited liability company (the “Company”), accepts no responsibility for claims, damages, losses or injuries arising from the tank or any malfunction thereof.

Acknowledging the foregoing, you voluntarily assume all risks associated with the use of the Products with the full knowledge and appreciation of the risks involved.

The Company disclaims any liability for product defect claims that are due to misuse, improper product selection and/or misapplication of the Products. The Company offers a limited one year, (365) day warranty for each of the Products. If, during the ninety (365) day warranty period (the “Warranty Period”), which shall commence on the original purchase date, a specific component of the Product fails, the Company will repair or replace it at no cost to you. Notwithstanding the foregoing, the purchaser is responsible for all shipping charges associated with sending the Product to the Company for repair and for its return to the purchaser. If, however, any component of the Product fails after the expiration of the Warranty Period, the warranty coverage does not extend to those components or to any damage they may cause. After the expiration of the Warranty Period, the Company shall not be responsible for the performance of the Products, including any component(s) that were repaired or replaced. This limited warranty shall not apply to failure caused by accident, alterations, misuse or abuse of the Products. This warranty is not transferrable. At all times, the purchase price of the Products shall be nonrefundable. Notwithstanding the foregoing, the Company may, in its discretion, accept the return of a new, unused Product in re-saleable condition subject to a twenty-five percent (25%) restocking fee and payment by the purchaser of all shipping charges associated with the return of the Product to the Company. If the Company determines, in its reasonable discretion, that the returned Product has been used, no refund shall be issued to the purchaser.

The Products are provided on an “as is” with all faults basis and with no warranty except the express warranty set forth above. To the maximum extent permissible by law, the Company disclaims all other warranties, including, but not limited to, the implied warranty of merchantability and the implied warranty of fitness for a particular purpose. The use of the Products is at the sole risk of the user. Under no circumstances shall the Company, its members, managers, officers, agents, employees, successors or assigns be liable for any injuries or damages whatsoever to any person or property arising from the use of the Products, which shall include, but not be limited to, consequential, incidental, special, exemplary or punitive damages. To the maximum extent permissible by law, the Company’s liability in all events is limited to, and shall not exceed, the purchase price paid for any Product that gives rise to any liability.

Excluding any services provided to you by the Company under a separate written agreement, these Terms and Conditions constitute the entire agreement between you and the Company regarding the use of the Products and supersede any and all previous and contemporaneous oral and written agreements between you and the Company regarding your use of the Products.

Club Cannon® and its associated logo are trademarks of the Company. You may not use any of the Company’s trademarks or logos without the Company’s prior written consent. Unless otherwise noted, all materials, including but not limited to the Company’s Web site(s), all articles, text, graphics, logos, images, illustrations, designs, icons, photographs, video clips, audio clips, all menu pages, underlying HTML code, and software that is part of the Web site(s), are protected under copyright laws and are the trademarks, trade dress and/or other intellectual properties owned, controlled or licensed by the Company or are otherwise part of the public domain.

The Company’s Web site(s) (excluding linked sites) is controlled by the Company from its office within the State of California, U.S.A. By accessing the Web site(s) and/or purchasing the Products, you and the Company agree that all matters relating to your access to, or use of, the Web site(s) and/or the Products shall be governed by the statutes and laws of the State of California, without regard to conflicts of laws principles. You and the Company also agree and hereby submit to the exclusive personal jurisdiction and venue of the Superior Court of San Luis Obispo County and the United States District Court for the Central District of California with respect to such matters. Those who choose to access the Web site(s) and/or purchase the Products from locations outside California shall be responsible for compliance with local laws, if and to the extent local laws are applicable. Notwithstanding the foregoing, you agree that the Company shall still be allowed to apply for injunctive relief (or an equivalent type of urgent legal relief) in any jurisdiction.

Except for any claim seeking the exercise of the injunctive or equitable powers of a court of competent jurisdiction, any action to enforce or interpret this Agreement, or to resolve disputes with respect to this Agreement, shall be settled by arbitration in accordance with California Code of Civil Procedure Sections 1280 through 1294.2 and any successor provisions thereto. The provisions of California Code of Civil Procedure Section 1283.05 regarding the right to take depositions and obtain discovery shall apply to the arbitration. Arbitration shall be the exclusive dispute resolution process. Any party may commence arbitration by sending a written demand for arbitration to the other parties. Such demand shall set forth the nature of the matter to be resolved by arbitration. The place of arbitration shall be in the County of San Luis Obispo, California. The substantive law of the State of California shall be applied by the arbitrator to the resolution of the dispute. The parties shall share equally all initial costs of arbitration. The prevailing party shall be entitled to reimbursement of attorneys’ fees, costs, and expenses incurred in connection with the arbitration. All decisions of the arbitrator shall be final, binding, and conclusive on all parties. Judgment may be entered upon any such decision in accordance with applicable law in any court having jurisdiction thereof. The arbitrator (if permitted under applicable law) or such court may issue a writ of execution to enforce the arbitrator’s decision.

If, for any reason, a court of competent jurisdiction finds any provision of these Terms and Conditions, or portion thereof, to be unenforceable, that provision shall be enforced to the maximum extent permissible so as to effect the intent of the Company as reflected by that provision, and the remainder of these Terms and Conditions shall continue in full force and effect. Any failure by the Company to enforce or exercise any provision of these Terms and Conditions or related rights shall not constitute a waiver of that right or provision.

If any legal proceeding, arbitration or other action is brought or threatened for the enforcement or interpretation of these Terms and Conditions, or because of an alleged dispute, breach, default or misrepresentation in connection with any of the provisions of these Terms and Conditions, and the prevailing party in any such action(s) should incur any legal fees, including, but not limited to, attorneys’ fees, paralegal fees, expert witness fees and other similar costs, the successful or prevailing party or parties to any such dispute or action shall be entitled to recover their reasonable attorneys’ fees and additional legal costs incurred, together with any other relief to which they may otherwise be entitled, as determined by an arbitrator, judge at trial, or upon appeal or petition.

The Company may make changes to these Terms and Conditions from time to time. When changes are made, the Company will post a new version of the Terms and Conditions on the Web site(s) and enclose a copy of the then-applicable Terms and Conditions in future purchases of the Products.

CONTACT US



CLUBCANNON®

856 Ricardo Ct, San Luis Obispo, CA 93401

888-804-8175

info@clubcannon.com ● www.clubcannon.com